

FILE BOOKS OF TOWN BOOKS FROM MAPS AS SHOWN BY THE FOLLOWING:

- ① 18792
- ② 18793
- ③ 18794
- ④ 18795
- ⑤ 18796
- ⑥ 18797
- ⑦ 18798
- ⑧ 18799
- ⑨ 18800
- ⑩ 18801
- ⑪ 18802
- ⑫ 18803
- ⑬ 18804
- ⑭ 18805
- ⑮ 18806
- ⑯ 18807
- ⑰ 18808
- ⑱ 18809
- ⑲ 18810
- ⑳ 18811
- ㉑ 18812
- ㉒ 18813
- ㉓ 18814
- ㉔ 18815
- ㉕ 18816
- ㉖ 18817
- ㉗ 18818
- ㉘ 18819
- ㉙ 18820
- ㉚ 18821
- ㉛ 18822
- ㉜ 18823
- ㉝ 18824
- ㉞ 18825
- ㉟ 18826
- ㊱ 18827
- ㊲ 18828
- ㊳ 18829
- ㊴ 18830
- ㊵ 18831
- ㊶ 18832
- ㊷ 18833
- ㊸ 18834
- ㊹ 18835
- ㊺ 18836
- ㊻ 18837
- ㊼ 18838
- ㊽ 18839
- ㊾ 18840
- ㊿ 18841

NOTE: THE MAPS SHOWN ABOVE ARE THE ORIGINAL RECORDS OF THE TOWN OF WASHINGTON, D.C. AND ARE NOT TO BE USED AS A BASIS FOR ANY OTHER RECORDS.

REVISION OF LOT 181, SECTION CEDAR RIDGE AT INLAND GREENS TRACT, MAP BOOK 45, PAGE 231 (REVISED 1987) AND LOT 181, SECTION CEDAR RIDGE AT INLAND GREENS TRACT, MAP BOOK 45, PAGE 231 (REVISED 1987).

RECONFIGURATION OF VARIOUS TRACTS INLAND GREENS, 4 CEDAR RIDGE AT INLAND GREENS TRACT, MAP BOOK 45, PAGE 231 (REVISED 1987) AND LOT 181, SECTION CEDAR RIDGE AT INLAND GREENS TRACT, MAP BOOK 45, PAGE 231 (REVISED 1987).

RECONFIGURATION OF VARIOUS TRACTS INLAND GREENS, 4 CEDAR RIDGE AT INLAND GREENS TRACT, MAP BOOK 45, PAGE 231 (REVISED 1987) AND LOT 181, SECTION CEDAR RIDGE AT INLAND GREENS TRACT, MAP BOOK 45, PAGE 231 (REVISED 1987).

RECONFIGURATION OF VARIOUS TRACTS INLAND GREENS, 4 CEDAR RIDGE AT INLAND GREENS TRACT, MAP BOOK 45, PAGE 231 (REVISED 1987) AND LOT 181, SECTION CEDAR RIDGE AT INLAND GREENS TRACT, MAP BOOK 45, PAGE 231 (REVISED 1987).

RECONFIGURATION OF VARIOUS TRACTS INLAND GREENS, 4 CEDAR RIDGE AT INLAND GREENS TRACT, MAP BOOK 45, PAGE 231 (REVISED 1987) AND LOT 181, SECTION CEDAR RIDGE AT INLAND GREENS TRACT, MAP BOOK 45, PAGE 231 (REVISED 1987).

RECONFIGURATION OF VARIOUS TRACTS INLAND GREENS, 4 CEDAR RIDGE AT INLAND GREENS TRACT, MAP BOOK 45, PAGE 231 (REVISED 1987) AND LOT 181, SECTION CEDAR RIDGE AT INLAND GREENS TRACT, MAP BOOK 45, PAGE 231 (REVISED 1987).

RECONFIGURATION OF VARIOUS TRACTS INLAND GREENS, 4 CEDAR RIDGE AT INLAND GREENS TRACT, MAP BOOK 45, PAGE 231 (REVISED 1987) AND LOT 181, SECTION CEDAR RIDGE AT INLAND GREENS TRACT, MAP BOOK 45, PAGE 231 (REVISED 1987).

RECONFIGURATION OF VARIOUS TRACTS INLAND GREENS, 4 CEDAR RIDGE AT INLAND GREENS TRACT, MAP BOOK 45, PAGE 231 (REVISED 1987) AND LOT 181, SECTION CEDAR RIDGE AT INLAND GREENS TRACT, MAP BOOK 45, PAGE 231 (REVISED 1987).

RECONFIGURATION OF VARIOUS TRACTS INLAND GREENS, 4 CEDAR RIDGE AT INLAND GREENS TRACT, MAP BOOK 45, PAGE 231 (REVISED 1987) AND LOT 181, SECTION CEDAR RIDGE AT INLAND GREENS TRACT, MAP BOOK 45, PAGE 231 (REVISED 1987).

RECONFIGURATION OF VARIOUS TRACTS INLAND GREENS, 4 CEDAR RIDGE AT INLAND GREENS TRACT, MAP BOOK 45, PAGE 231 (REVISED 1987) AND LOT 181, SECTION CEDAR RIDGE AT INLAND GREENS TRACT, MAP BOOK 45, PAGE 231 (REVISED 1987).

RECONFIGURATION OF VARIOUS TRACTS INLAND GREENS, 4 CEDAR RIDGE AT INLAND GREENS TRACT, MAP BOOK 45, PAGE 231 (REVISED 1987) AND LOT 181, SECTION CEDAR RIDGE AT INLAND GREENS TRACT, MAP BOOK 45, PAGE 231 (REVISED 1987).

RECONFIGURATION OF VARIOUS TRACTS INLAND GREENS, 4 CEDAR RIDGE AT INLAND GREENS TRACT, MAP BOOK 45, PAGE 231 (REVISED 1987) AND LOT 181, SECTION CEDAR RIDGE AT INLAND GREENS TRACT, MAP BOOK 45, PAGE 231 (REVISED 1987).

RECONFIGURATION OF VARIOUS TRACTS INLAND GREENS, 4 CEDAR RIDGE AT INLAND GREENS TRACT, MAP BOOK 45, PAGE 231 (REVISED 1987) AND LOT 181, SECTION CEDAR RIDGE AT INLAND GREENS TRACT, MAP BOOK 45, PAGE 231 (REVISED 1987).

RECONFIGURATION OF VARIOUS TRACTS INLAND GREENS, 4 CEDAR RIDGE AT INLAND GREENS TRACT, MAP BOOK 45, PAGE 231 (REVISED 1987) AND LOT 181, SECTION CEDAR RIDGE AT INLAND GREENS TRACT, MAP BOOK 45, PAGE 231 (REVISED 1987).

RECONFIGURATION OF VARIOUS TRACTS INLAND GREENS, 4 CEDAR RIDGE AT INLAND GREENS TRACT, MAP BOOK 45, PAGE 231 (REVISED 1987) AND LOT 181, SECTION CEDAR RIDGE AT INLAND GREENS TRACT, MAP BOOK 45, PAGE 231 (REVISED 1987).

RECONFIGURATION OF VARIOUS TRACTS INLAND GREENS, 4 CEDAR RIDGE AT INLAND GREENS TRACT, MAP BOOK 45, PAGE 231 (REVISED 1987) AND LOT 181, SECTION CEDAR RIDGE AT INLAND GREENS TRACT, MAP BOOK 45, PAGE 231 (REVISED 1987).

RECONFIGURATION OF VARIOUS TRACTS INLAND GREENS, 4 CEDAR RIDGE AT INLAND GREENS TRACT, MAP BOOK 45, PAGE 231 (REVISED 1987) AND LOT 181, SECTION CEDAR RIDGE AT INLAND GREENS TRACT, MAP BOOK 45, PAGE 231 (REVISED 1987).

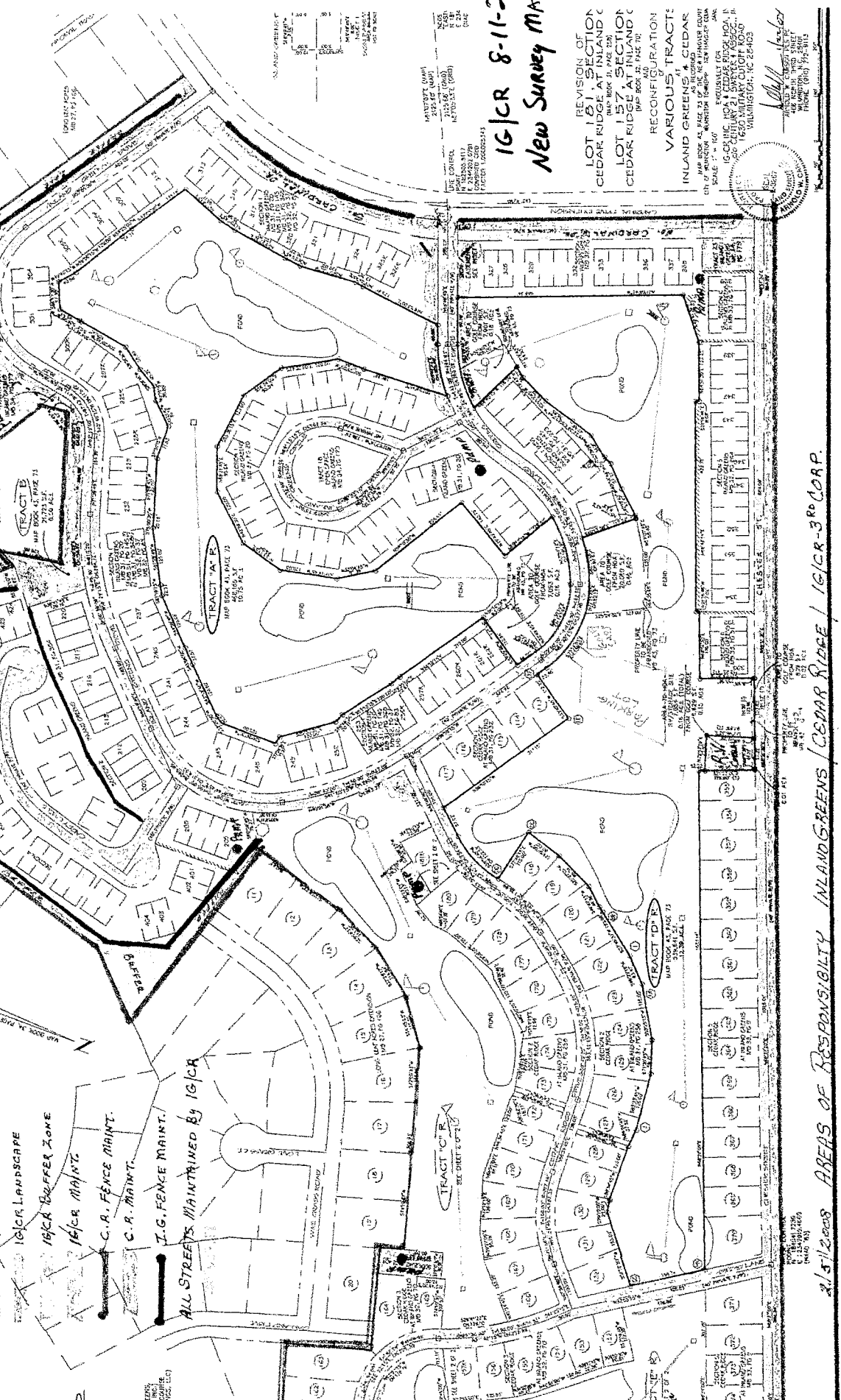

RECONFIGURATION OF VARIOUS TRACTS INLAND GREENS, 4 CEDAR RIDGE AT INLAND GREENS TRACT, MAP BOOK 45, PAGE 231 (REVISED 1987) AND LOT 181, SECTION CEDAR RIDGE AT INLAND GREENS TRACT, MAP BOOK 45, PAGE 231 (REVISED 1987).

16/CR 8-11-2007
New Survey Map

REVISION OF LOT 181, SECTION CEDAR RIDGE AT INLAND GREENS TRACT, MAP BOOK 45, PAGE 231 (REVISED 1987) AND LOT 181, SECTION CEDAR RIDGE AT INLAND GREENS TRACT, MAP BOOK 45, PAGE 231 (REVISED 1987).

AREAS OF RESPONSIBILITY INLAND GREENS CEDAR RIDGE / 16/CR-3 RO CORP.

- COMMUNITY BOUNDARIES
- SEWER FENCE MAINT.
- IG/CR LANDSCAPE
- 16/CR BUFFER ZONE
- 16/CR MAINT.
- C.A. FENCE MAINT.
- C.R. MAINT.
- I.G. FENCE MAINT.
- ALL STREETS MAINTAINED BY IG/CR

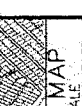

MAP SCALE

DATE OF SURVEY: 8/11/2007
BY: [Signature]
PROJECT: 16/CR-3 RO CORP.

PLANNING BOARD
APPROVED: [Signature]
DATE: 8/11/2007

RECORDS SECTION
APPROVED: [Signature]
DATE: 8/11/2007

ENGINEER
APPROVED: [Signature]
DATE: 8/11/2007

16/CR-3 RO CORP.
1600 MILITARY OUTPOST ROAD
WILMINGTON, NC 28403